

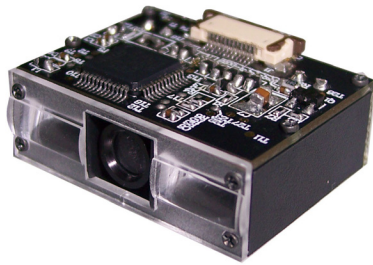

EM1300

1D CCD Scan Engine



Designed for OEM applications, this high performance CCD scan engine can easily be integrated into various solutions such as kiosks, ticketing machines, PDA's and many more.

Product Features

- **Ease of integration**

Compact (smaller than a paperclip) and easy to integrate design, image capture device with decoder on one board. The small form factor enables easy integration into various solutions.

- **Advanced Technology**

Includes core-technology **UIMG™**, which is independently designed and manufactured by Newland Auto-ID. **UIMG™** technology includes the optical, CMOS, digitizer, decoder, image processing & embedded systems. The scanner supports all global standard 1D barcode symbologies. Its' reading performance reaches and exceeds global standards. By using the accessories provided, the user can ideally set up the scanner to its user environment.

- **Intelligent Focus**

Advanced optical focusing system which senses the ambient environment and adjusts the optical automatically for a quick reading response.

Decode Zones

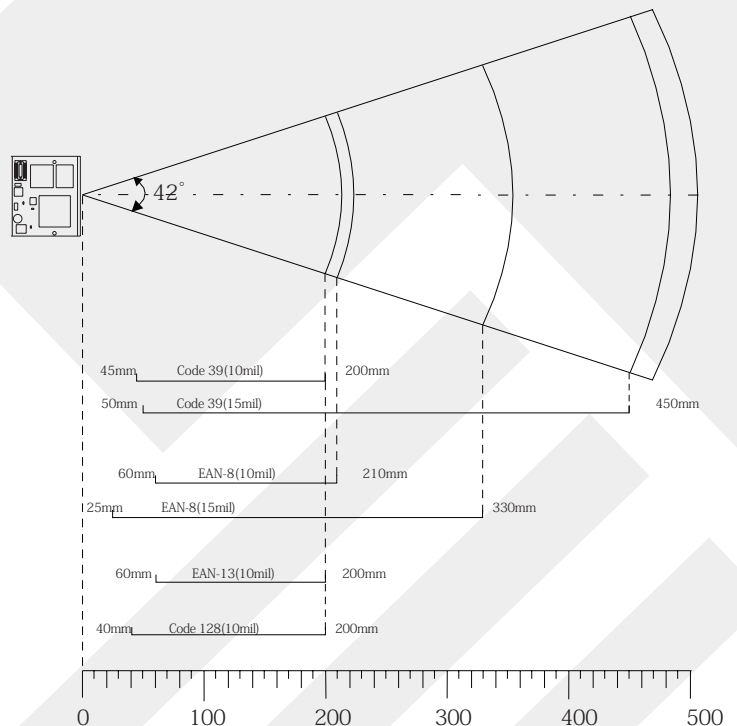



EM1300 Specifications

Performance

Interface	TTL232
Image Sensor	CCD
Resolving	2500
Scan Rate	300 scans/sec
Decode Rate	200 decodes/sec (default)
Symbologies	Code128, EAN-13, EAN-8, Code39, UPC-A, UPC-E, Codabar, Interleaved 2 of 5, ISBN/ISSN, Code 93, etc.
Precision	≥ 4mil (Condition:PCS=0.9, testing code: Code 39)
Light Source	LED(622 nm - 628 nm)
Light Intensity	265 LUX (130 mm)
Depth of Scan Field	EAN-8, 10mil, 60mm~210mm; EAN-8, 15mil, 25mm~330mm; EAN-13, 10mil, 60mm~200mm, Code39, 10mil, 45mm~200mm; Code39, 15mil, 50mm~450mm; Code128, 10mil, 40~200mm
Print Contrast Signal	≥ 30%
Pitch	±60°@ 0°Roll and 0° Skew
Roll	±20°@ 0°Pitch and 0° Skew
Skew	±45°@ 0°Roll and 0° Pitch
Illumination	0 ~ 100,000 LUX

Mechanical/ Electrical

Power Consumption	0.2 W
Voltage	DC 3.3 V
Current	Max 79.7 mA
	Working 39.4 mA
	Idle 1 mA
Weight	6g

Environment

Operate Temperature	-20°C - +60°C
Storage Temperature	-40°C - +85°C
Humidity	5% - 95% (non-condensing)
Certificates	FCC Part15 Class B, CE EMC Class B

Accessories

Evaluation Kit

EVK1300 The Evaluation Kit for EM1300, with trigger, beep functions and USB, RS232 interfaces.

Flex Cable

CBL1300R This cable connect to the RS232 port of EVK1300. With a standard female RS232 port to connect to standard male RS232 port. With a power port to accept power adapter supply.

CBL1300MU This cable connect to the USB Slave port of EM1300 with a USB-B male port. With a standard USB Slave port to connect to standard USB Host port.

Power

ADP50 The power adapter for EVK1300 by the CBL1300R. Output: DC5V, 2A; Input: AC100~240V, 50~60HZ

Dimensions (mm)

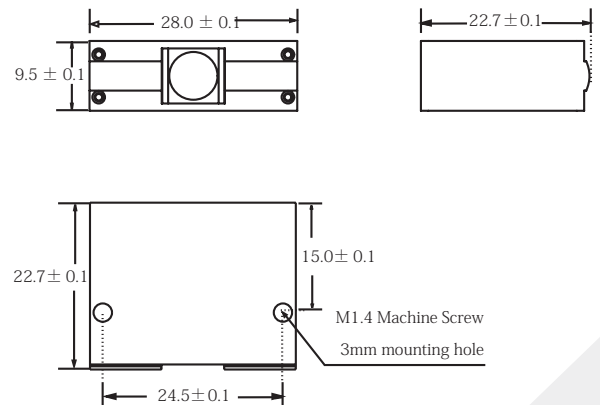

Applicable Accessories

- [Integration Manual / Programming Guide](#)

A manual to explain the user the basics of the scanner, how to integrate it and how to configure it. Furthermore, it enables the user to set the scanner to the specific wishes regarding scanning modes, readable barcodes and barcode formats.